

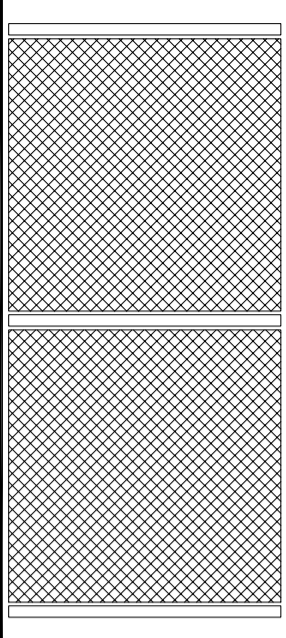

Wire Safety Fence @ 1.8m above Ground Level -
 Final Design to be Agreed with Electrical Supply
 Company

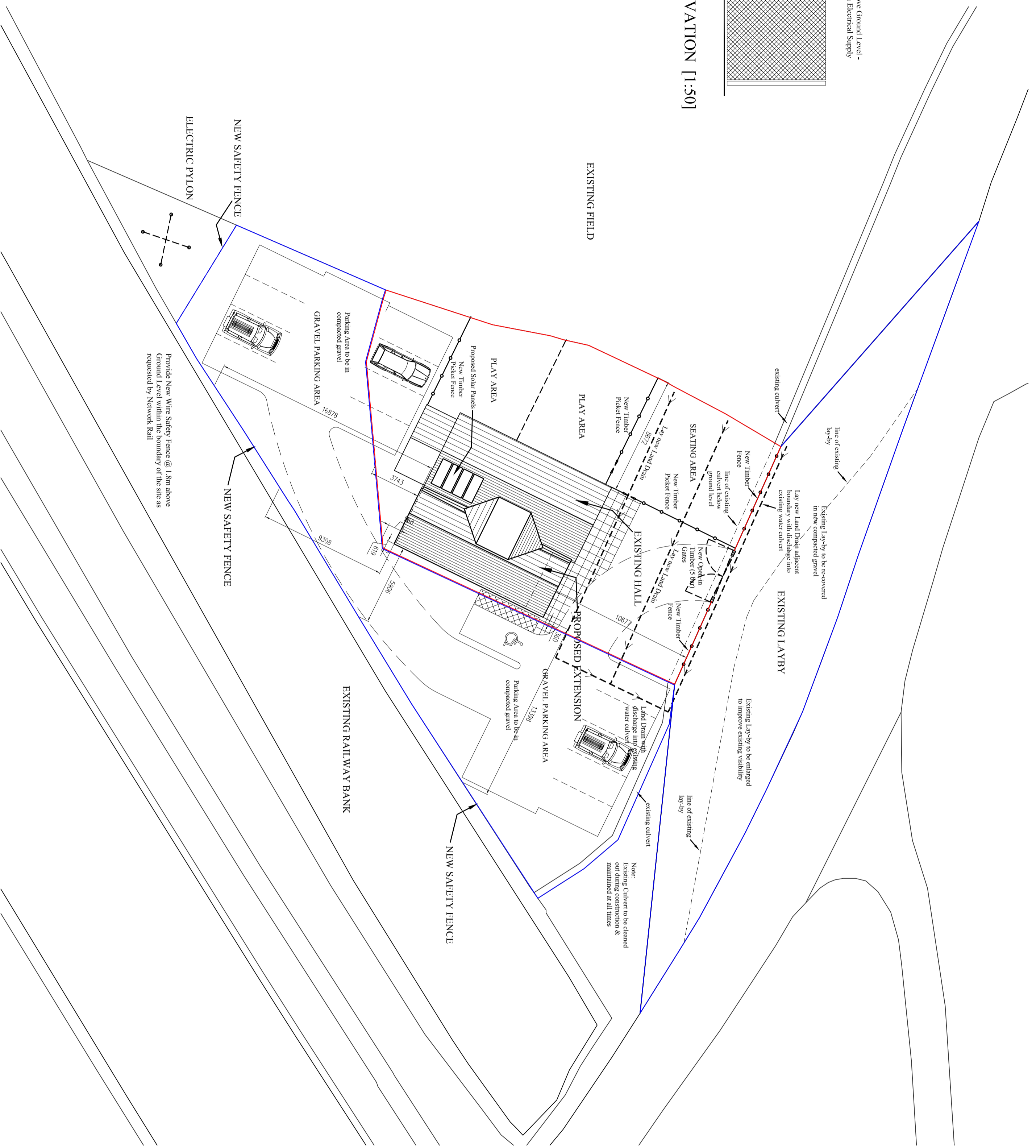

SAFETY FENCE ELEVATION [1:50]



NEW SAFETY FENCE
ELECTRIC PYLON

Provide New Wire Safety Fence @ 1.8m above
 Ground Level within the boundary of the site as
 requested by Network Rail

PROPOSED SITE PLAN [1:200]

Rev B Lay-by & Fencing Info Added
 Rev A Dimensions & Safety Fence Elevation Added

WAYNE CARD
 ARCHITECTURAL SERVICES
 Unit 2 Semley Business Park,
 Station Road, Semley, Shaftesbury,
 Dorset, SP7 9AN
 Tel:- (01747) 855802
 Mobile - 07970 984586

JOB TITLE:
 PROPOSED ALTERATIONS AT
 Semley Village Hall, Semley,
 Shaftesbury SP7 9AP

DRAWING TITLE:
 Proposed Site Plan

DRAWING No:	WAC12/SVH/S10	SCALE:	1:200 [A3]
REV:	A B	DATE:	16/07/12
DESIGNED BY:	MAC	DRAWN BY:	MAC

THIS DRAWING IS COPYRIGHT